XDS Rapid Content™ / Liquid™ Analyzer Spare Parts Manual

6005 7522 / Rev.4



All information is liable to change without prior notice. For latest information about documentation updates for your specific instrument, please contact your local FOSS representative.

Rev.	Date of Issue	Revised Material
1	2013-04-02	First issue
2	2014-02-24	New spare part
3	2014-05-13	Spare parts optimization
4	2015-01-12	General update

Table of Contents

1	General.....	1
2	Spare Parts.....	2
3	Spare Parts.....	4
4	Spare Parts.....	6
5	Spare Parts.....	8
6	Spare Parts.....	10
7	XDS Autosampler.....	12
8	Index.....	14

1 General

This document contains Spare Parts for XDS Rapid Content™ / Liquid™ Analyzer.



Warning

Please read Safety Precautions in the Service Manual prior to maintenance or exchange of spare parts.

The system may only be repaired by FOSS personnel or by other personnel approved by FOSS.

N.i. = Not illustrated

2 Spare Parts

Pos.	Part No.	Description	Note
1	60023729	Monochromator box assay	
1	18103729	Monochromator box assay, exchange	
2	60025030	Lamp controller PCB assay	
24	00587410	Hot swap vertical	N.i.

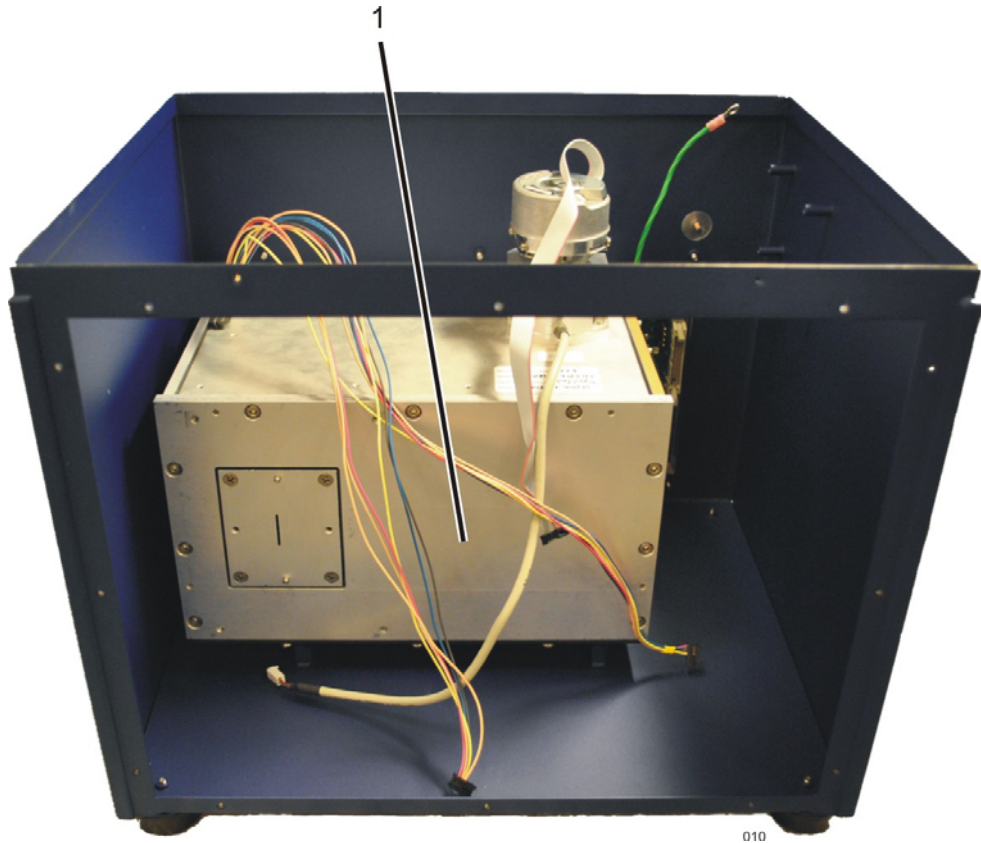

Fig. 1

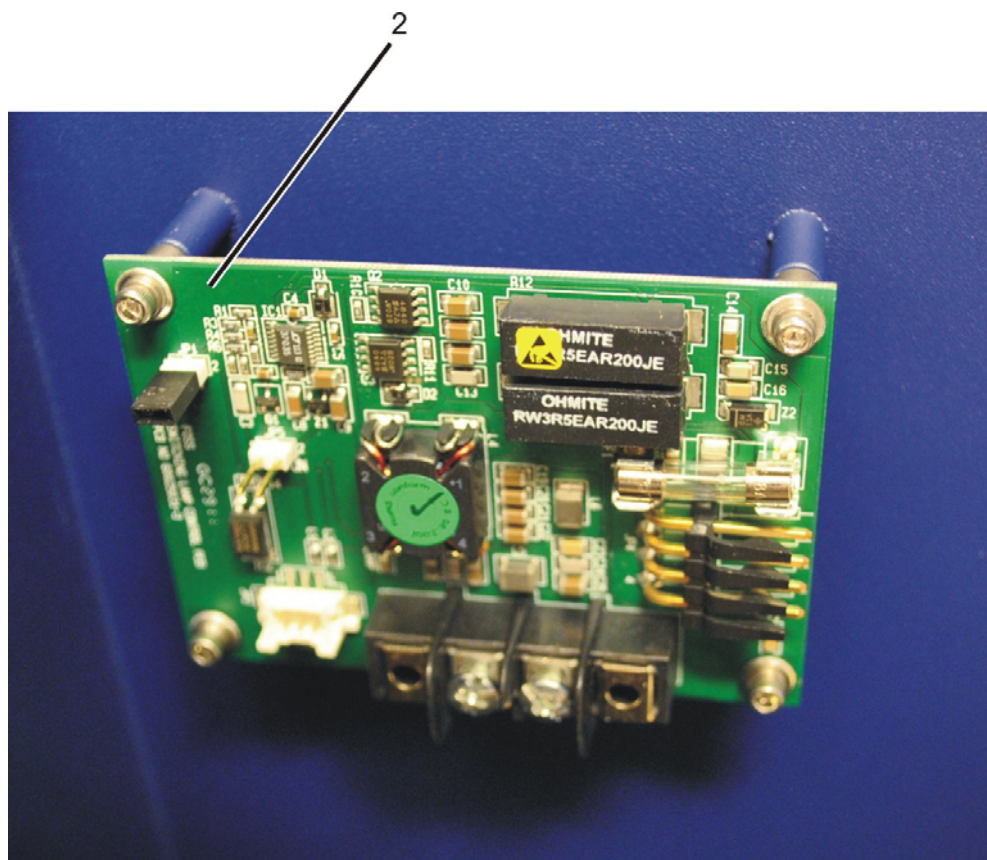
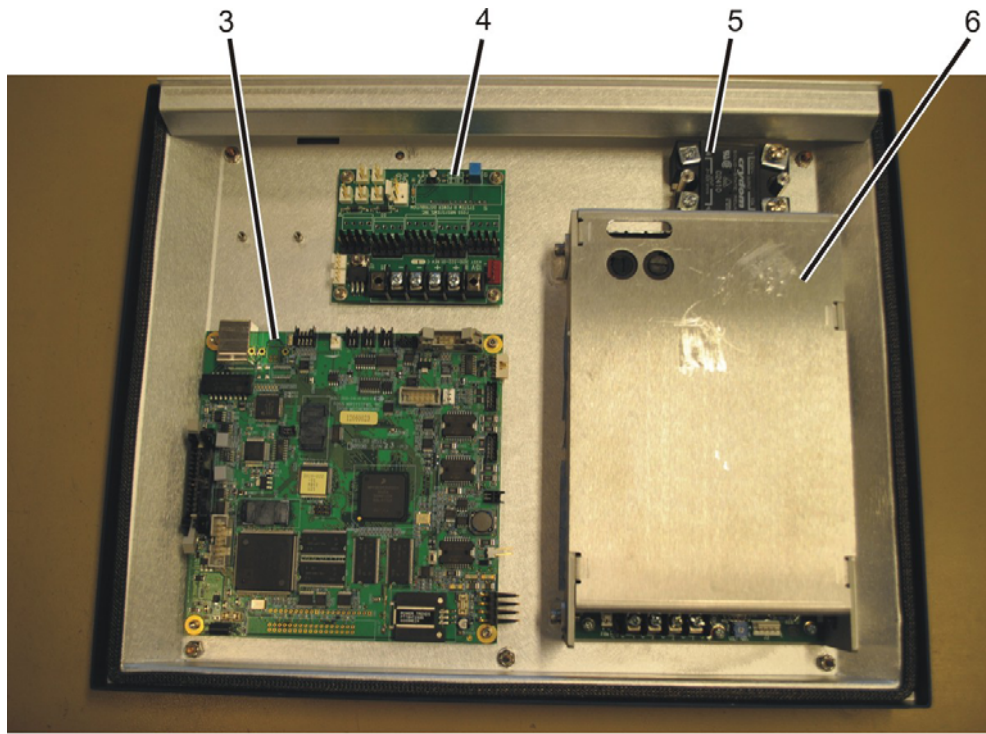

Fig. 2

3 Spare Parts

Pos.	Part No.	Description	Note
3	60023714	Motherboard assay	
4	00587576	Power distribution PCB	
5	60010871	Solid state relay	
6	60009720	Power supply	
7	60010253	Horizontal transport complete	Pos. 9-11
8	60010201	RCA window	
28	60055759	Cable assay P/S	N.i.
29	60055760	Cable assay Motherboard	N.i.



035

Fig. 3

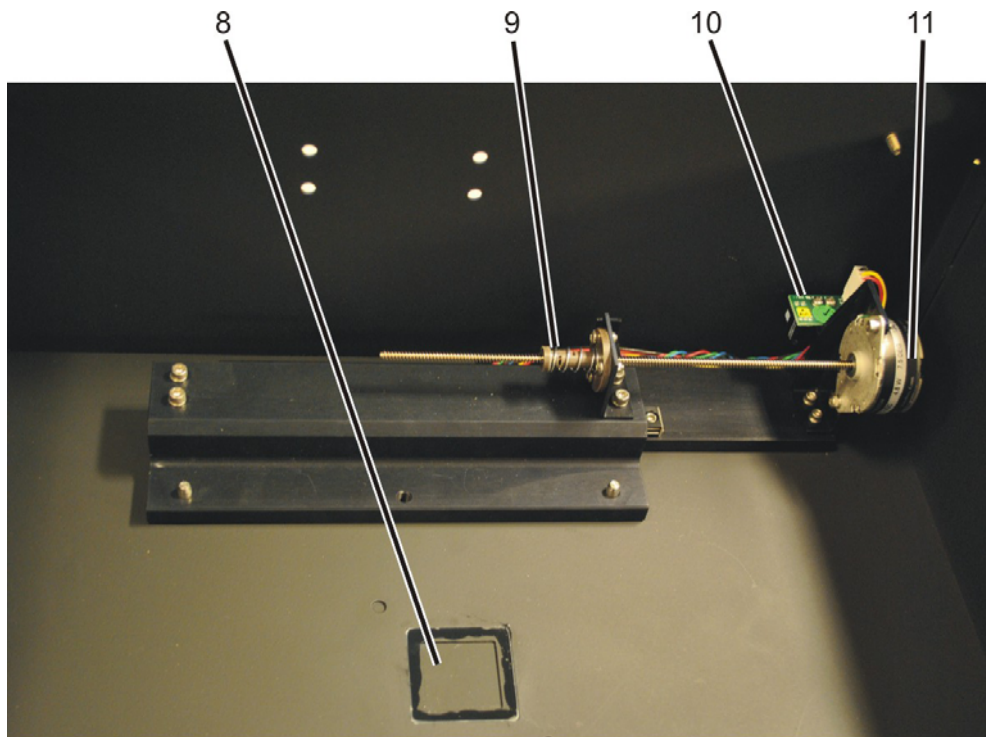

117

Fig. 4

4 Spare Parts

Pos.	Part No.	Description	Note
12	00587659	Amplifier PCB RCA	
13	00587378	RCA Module control assay	
14	60010177	Autogain detector subassay	
20	60011485	Stepper motor	
21	60011698	Friction hinge RCA	N.i.
25	00587451	Hot swap right angle	N.i.

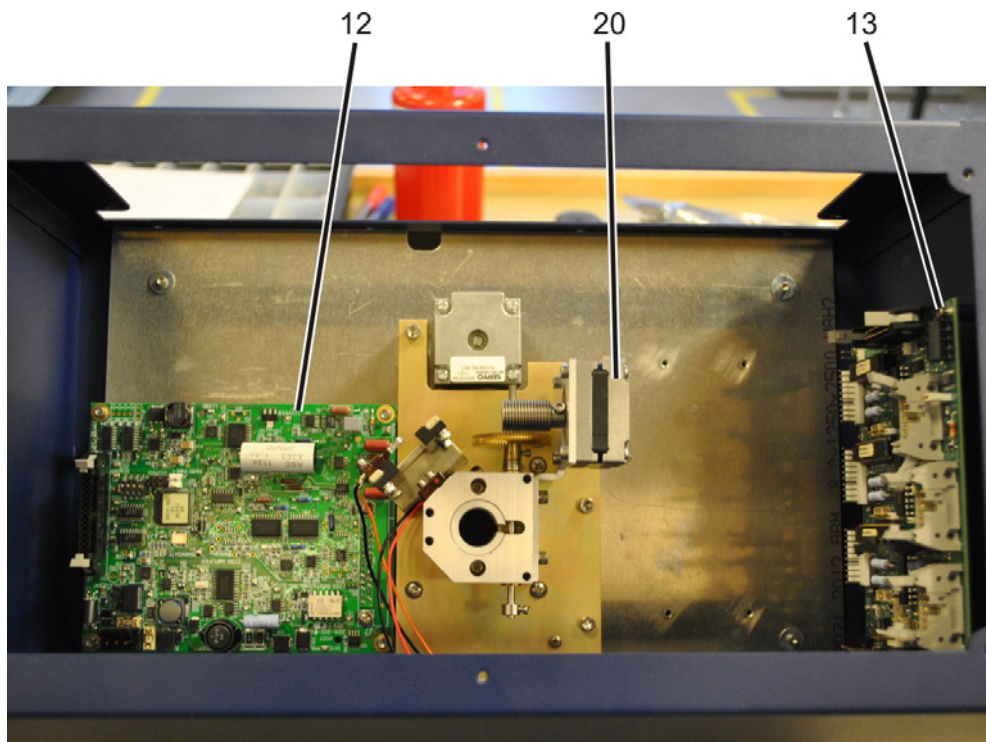

097B

Fig. 5

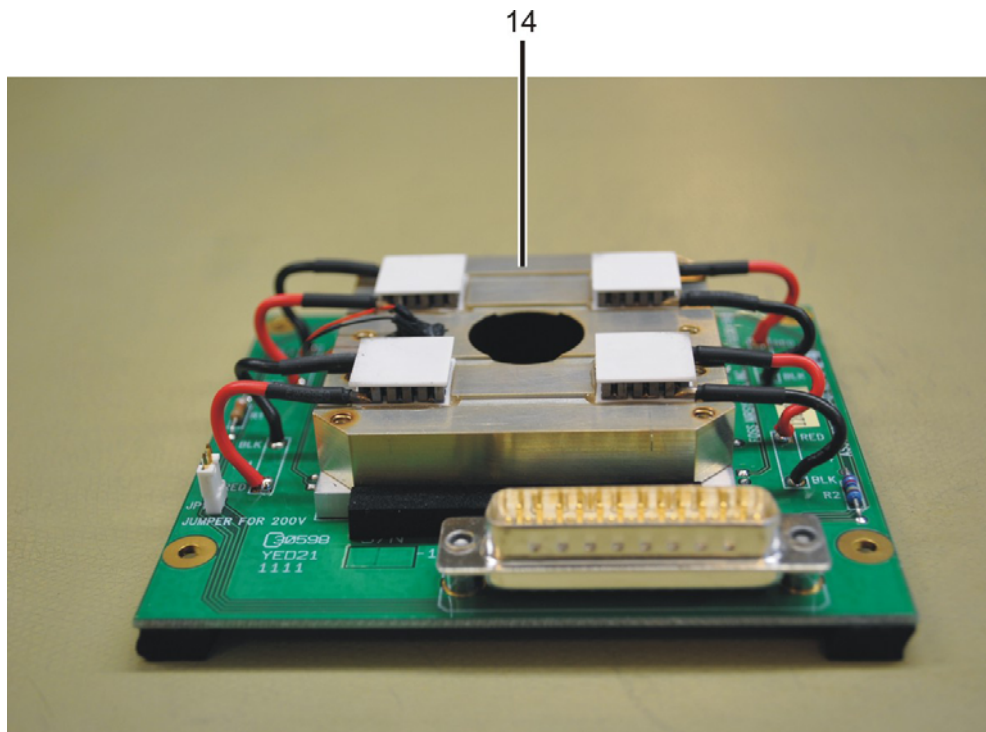

137

Fig. 6

5 Spare Parts

Pos.	Part No.	Description	Note
15	00587642	Amplifier PCB RLA	
16	60010346	Sample tray assay w. cable harness	
17	00587675	RLA Module control assay	
20	60038954	RLA Detector	
22	60011087	Temp controller RLA	N.i.
23	60010346	Sample tray assay RLA	N.i.

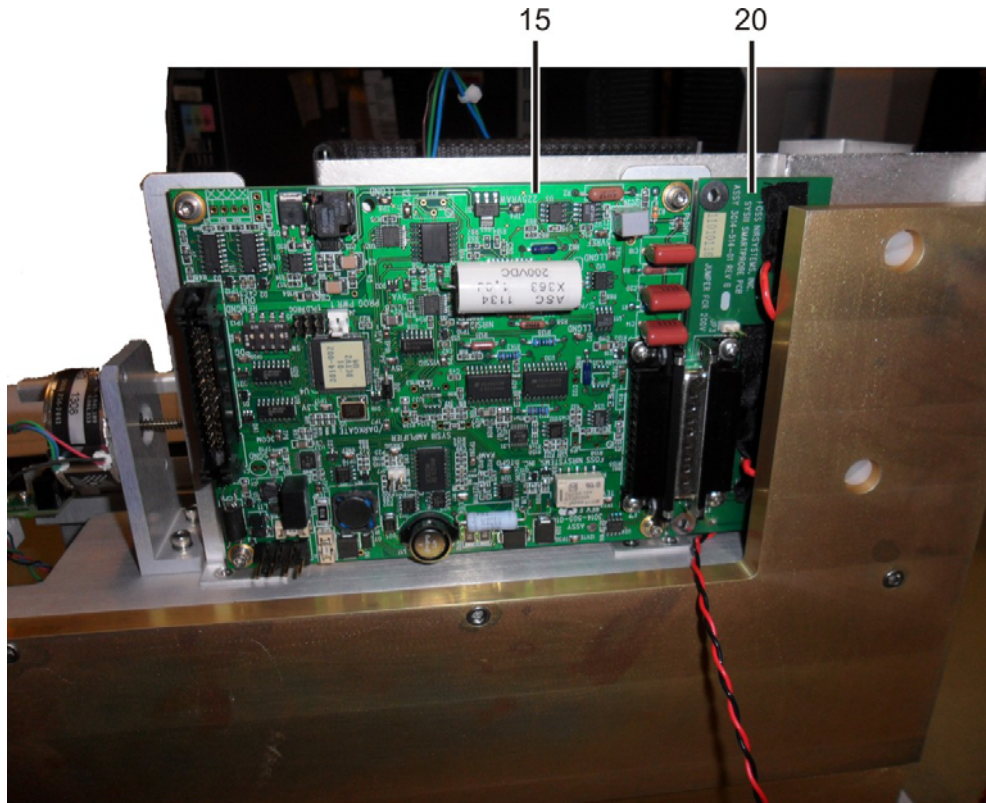

2277A

Fig. 7

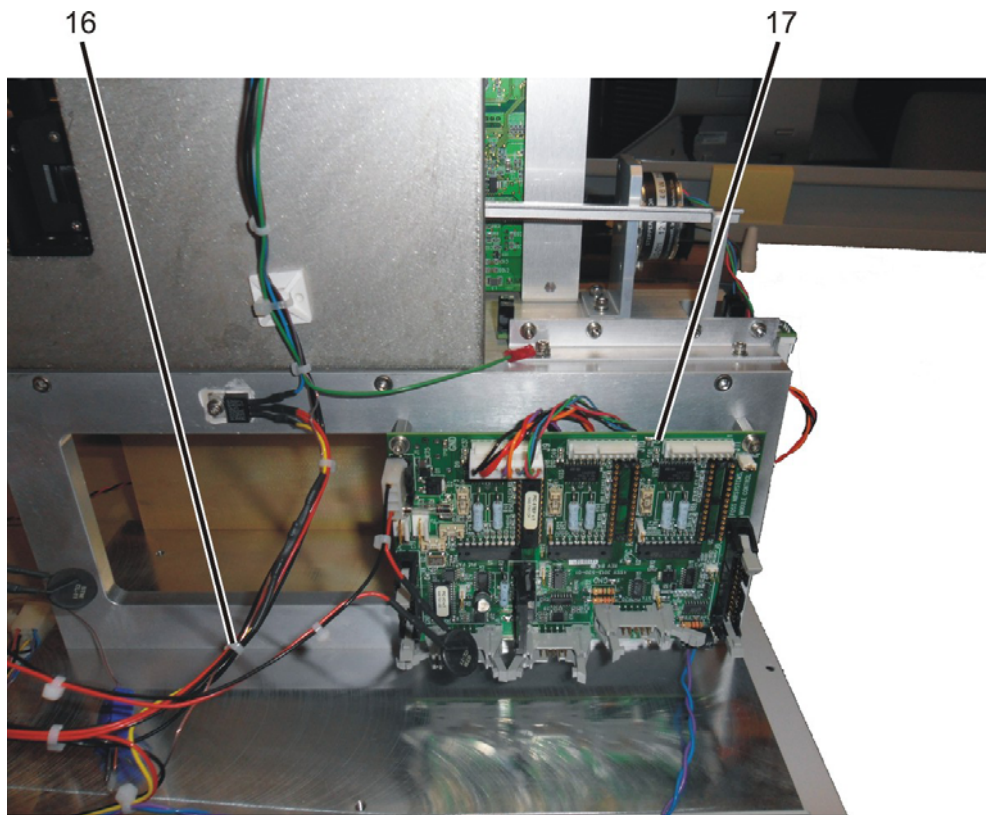

2274

Fig. 8

6 Spare Parts

Pos.	Part No.	Description	Note
18	60022821	Lamp	
19	60055373	Fan filter	
26	60011465	Fan 60 mm	N.i.
27	60055758	Fan 92 mm	N.i.

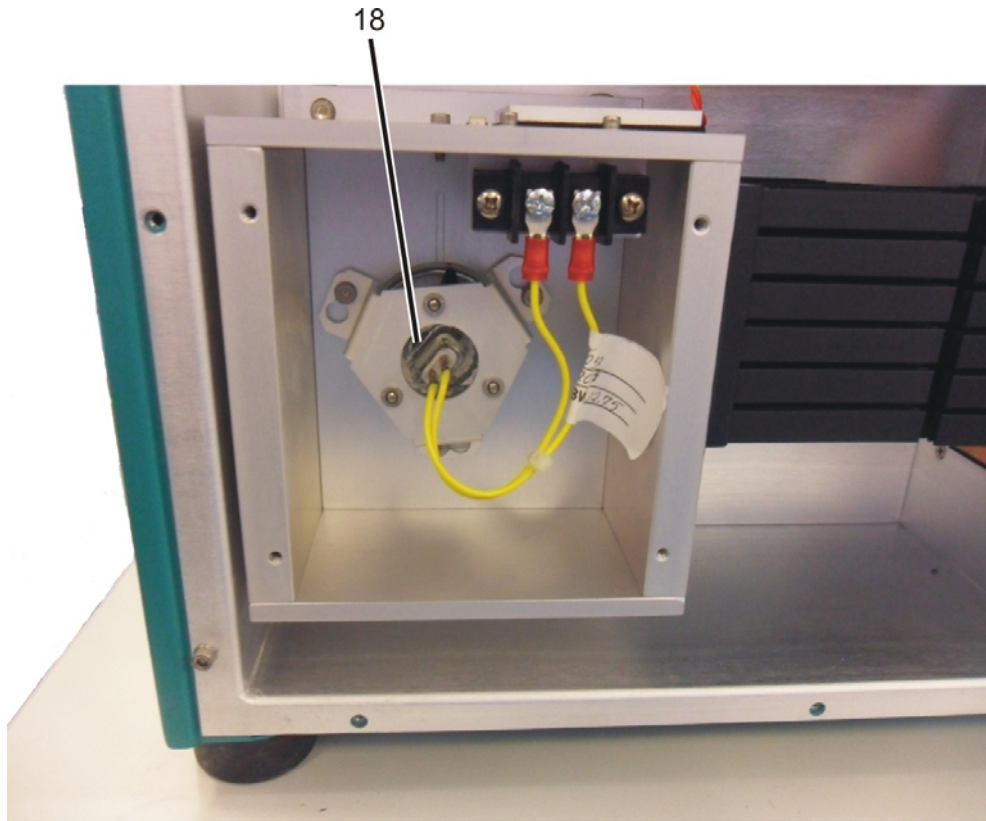

2283

Fig. 9

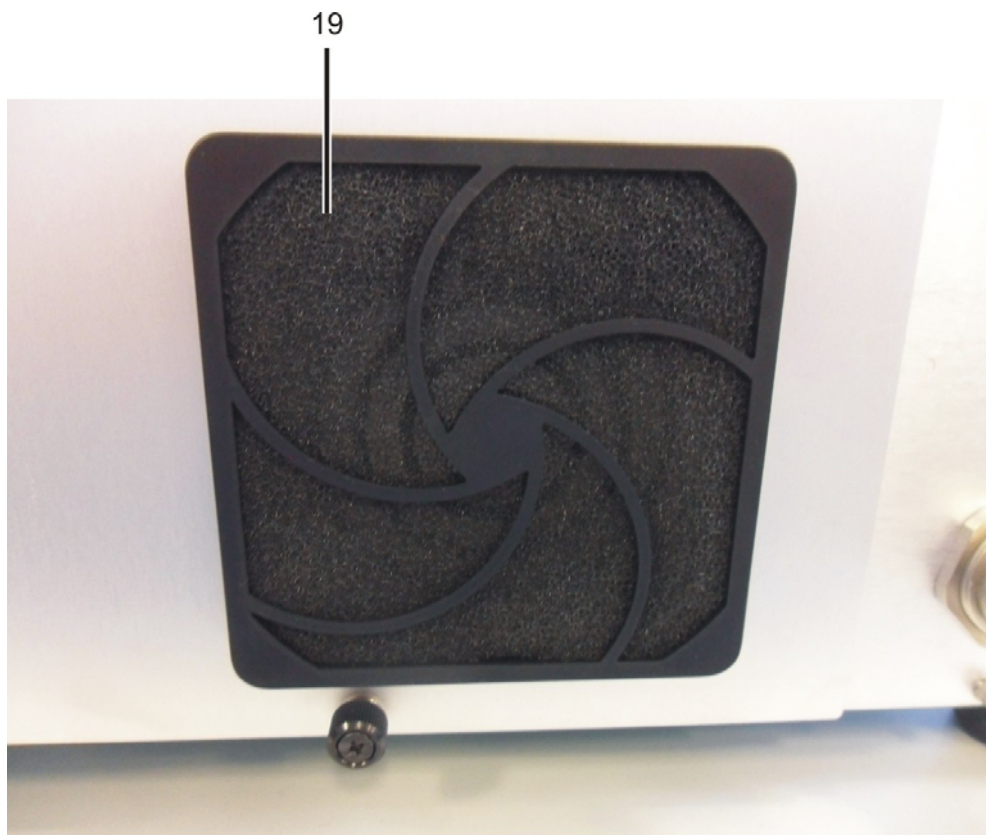

2286

Fig. 10

7 XDS Autosampler

Pos.	Part No.	Description	Note
1	60053383	Slide	
2	60053386	Spring	
3	60053385	Knob	
4	60053384	Teflon surface	
5	60053387	1x 6.5 In Ball Slide	

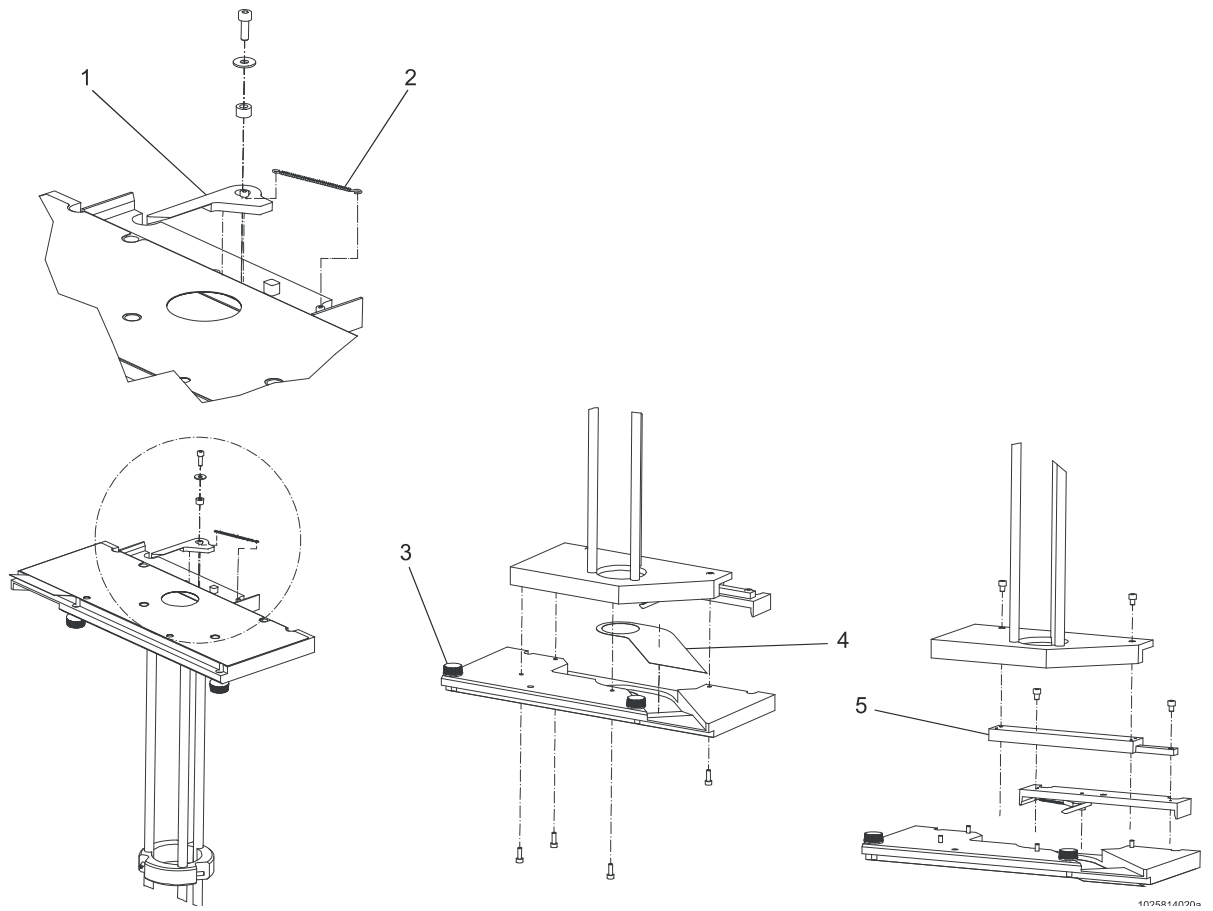

Fig. 11

8 Index

Part No.	Page	Part No.	Page
00587378	6	60011485	6
00587410	2	60011698	6
00587451	6	60022821	10
00587576	4	60023714	4
00587642	8	60023729	2
00587659	6	60025030	2
00587675	8	60038954	8
18103729	2	60053383	12
60009720	4	60053384	12
60010177	6	60053385	12
60010201	4	60053386	12
60010253	4	60053387	12
60010346	8	60055373	10
60010871	4	60055758	10
60011087	8	60055759	4
60011465	10	60055760	4